



Collets Clamps

COLLIERS DE SERRAGE "TRIDON"

HOSE CLAMPS "TRIDON"

BANDE & LOGEMENT 1/2" - ACIER INOXYDABLE 201/301 / VIS 5/16" HEX. ACIER PLAQUÉ ZINC
 BAND & HOUSING 1/2" - 201/301 STAINLESS STEEL / SCREW 5/16" HEX. STEEL ZINC PLATED

INOX / ZINC



	CODE	REF	MIN	MAX	BTE/BOX
LEGION	1181*	4	1/4	5/8	10
	1175*	5	7/16	11/16	10
	1181A	6	3/8	7/8	10
	1182	8	7/16	1	10
	1183	10	9/16	1-1/16	10
	1183A	12	9/16	1-1/4	10
	1184	16	11/16	1-1/2	10
	1184A	20	3/4	1-3/4	10
	1185	24	1-1/16	2	10
	1185A	28	1-5/16	2-1/4	10
	1186	32	1-9/16	2-1/2	10
	1186A	36	1-1/16	2-3/4	10
TRIDON	1186B	40	2-1/16	3	10
	1187	44	2-5/16	3-1/4	10
	1187A	48	2-9/16	3-1/2	10
	1188	52	2-13/16	3-3/4	10
	1188A	56	3-1/16	4	10
	1164A	60	3-5/16	4-1/4	10
	1164	64	2-1/2	4-1/2	10

	CODE	REF	MIN	MAX	BTE/BOX
TRIDON	1162	72	3	5	10
	1640	80	3-1/2	5-1/2	10
	1641	84	3-3/4	5-3/4	10
	1642	88	4	6	10
	1643	96	4-1/2	6-1/2	10
	1644	104	5	7	10
	1645	116	5-3/4	7-3/4	1
	1648	128	6-1/2	8-1/2	1
	1650	152	2	10	1
	1651	164	1-3/4	10-3/4	1
	1652	188	2	12-1/4	1
	1646	200	11	13	1
	1653	212	11-3/4	13-3/4	1
	1658	224	12-1/2	14-1/2	1
	1647	236	13-1/4	15-1/4	1
	1649	248	1-3/4	16	1
	1654	270	15-3/8	17-3/4	1
	1655	312	18	20	1
	1656	390	22-7/8	24-7/8	1

ASSORTIMENTS / KITS



TIROIR EN MÉTAL LARGE LARGE METAL CASE

120 mcx / pcs

Comprend collet / Includes:
4, 6, 8, 10, 12, 16, 20, 24, 28, 32, 36, 40
(10 de chaque / 10 of each)

#ASF-2193
#260-123 Tiroir universel seul / only

COFFRE EN MÉTAL LARGE METAL CASE

200 mcx / pcs

Comprend collet / Includes:
4, 6, 8, 10, 12, 16, 20, 24, 28, 32, 36, 40, 44,
48, 52, 56, 60, 64, 72, 96
(10 de Chaque / 10 of each)

#ASF-2194
#260-107 Coffre seul / Case only



SUPPORT EN MÉTAL METAL RACK

100 mcx / 100 pcs

Comprend collet / Includes:
4, 6, 10, 12, 16, 20, 24, 28, 32, 36
(10 de chaque / 10 of each)

#ASF-097
#260-HC10 Support seul / rack only

SUPPORT EN MÉTAL METAL RACK

50 mcx / 50 pcs

Comprend collet / Includes:
40, 48, 52, 56, 72
(10 de chaque / 10 of each)

#ASF-097L
#260-HC5 Support seul / rack only



COLLIERS DE SERRAGE EN CARBONNE "T-BOLT"

"T-BOLT" CARBON HOSE CLAMPS

COLLIER À REBORD COURBÉ AIDE À PRÉVENIR LES DOMMAGES AU COUVRE-TUYAU LORS DU SERRAGE
 BAND HAS A BEVELED EDGE WHICH HELPS TO PREVENT DAMAGE TO THE HOSE COVER WHEN TIGHTENED



BANDE ACIER INOX, BOULON & LOGEMENT ACIER. STAINLESS STEEL BAND. CARBON STEEL BOLT & HOUSING NO. / PARTS	TOUT ACIER INOX ALL STAINLESS STEEL NO. / PARTS	RÉFÉRENCE REFERENCE	RAYON MIN. RANGE MIN.	RAYON MAX. RANGE MAX.	POIDS APPROX. APPROX WEIGHT	SERRAGE PIEDS LBS TORQUE FT LBS	LARGEUR COLLIER BAND WIDTH
706-3906	706-3939	17-19	22/32	24/32	0.090	4	3/4
706-3910	706-3940	20-22	25/32	28/32	0.094	4	3/4
706-3913	706-3942	23-25	29/32	1	0.095	4	3/4
706-3915	706-3943	26-28	1-1/32	1-3/32	0.099	4	3/4
706-3916	706-3944	29-31	1-5/32	1-7/32	0.121	7	3/4
706-3917	706-3945	32-35	1-9/32	1-12/32	0.143	7	3/4
706-3918	706-3946	36-39	1-13/32	1-17/32	0.154	7	3/4
706-3919	706-3947	40-43	1-18/32	1-22/32	0.163	7	3/4
706-3920	706-3948	44-47	1-23/32	1-27/32	0.183	7	3/4
706-3921	706-3949	48-51	1-28/32	2	0.205	7	3/4
706-3922	706-3950	52-55	2-2/32	2-5/32	0.209	7	3/4
706-3923	706-3951	56-59	2-7/32	2-10/32	0.220	7	3/4
706-3924	706-3952	60-63	2-11/32	2-15/32	0.227	7	3/4
706-3925	706-3953	64-67	2-17/32	2-20/32	0.282	15	3/4
706-3926	706-3954	68-73	2-22/32	2-28/32	0.352	15	1
706-3927	706-3955	74-79	2-29/32	3-3/32	0.361	15	1
706-3928	706-3956	80-85	3-5/32	3-10/32	0.383	15	1
706-3929	706-3957	86-91	3-12/32	3-18/32	0.385	15	1
706-3930	706-3958	92-97	3-20/32	3-26/32	0.403	15	1
706-3931	706-3959	98-103	3-27/32	4-2/32	0.418	15	1
706-3899	706-3932	104-112	4-3/32	4-12/32	0.440	26	1
706-3900	706-3933	113-121	4-14/32	4-24/32	0.453	26	1
706-3901	706-3934	122-130	4-25/32	5-4/32	0.460	26	1
706-3902	706-3935	131-139	5-4/32	5-16/32	0.506	26	1
706-3903	706-3936	140-148	5-16/32	5-28/32	0.682	26	1
706-3904	706-3937	149-161	5-28/32	6-12/32	0.711	26	1
706-3905	706-3938	162-174	6-12/32	6-28/32	0.726	26	1
706-3907	-	175-187	6-28/32	7-12/32	0.774	26	1
706-3908	-	188-200	7-12/32	7-28/32	0.825	26	1
706-3909	-	201-213	7-28/32	8-12/32	0.847	26	1
706-3911	-	214-226	8-12/32	8-28/32	0.880	26	1
706-3912	706-3941	227-239	8-28/32	9-12/32	0.902	26	1
706-3914		240-252	9-12/32	9-28/32	0.935	26	1

COLLIERS DE SERRAGE "TRIDON"

HOSE CLAMPS "TRIDON"

BANDE & LOGEMENT 1/2" & VIS 5/16" HEX. / ACIER INOXYDABLE "HIGH-NICKEL"
 BAND & HOUSING 1/2" & SCREW 5/16" HEX. / HIGH-NICKEL GRADE STAINLESS STEEL

INOX / INOX



#PRD	REF	MIN	MAX	BTE
4136*	4	7/32	5/8	10
4137*	5	7/16	11/16	10
4138	6	3/8	7/8	10
4139	8	7/16	1	10
4140	10	9/16	1-1/16	10
4141	12	9/16	1-1/4	10
4142	16	11/16	1-1/2	10
4143	20	3/4	1-3/4	10
4144	24	1-1/16	2	10
4145	28	1-5/16	2-1/4	10
4146	32	1-9/16	2-1/2	10
4147	36	1-1/16	2-3/4	10
4148	40	2-1/16	3	10
4149	44	2-5/16	3-1/4	10
4150	48	2-9/16	3-1/2	10
4151	52	2-13/16	3-3/4	10
4152	56	3-1/16	4	10
4153	60	3-5/16	4-1/4	10
4154	64	2-1/2	4-1/2	10
4155	72	3	5	10

#PRD	REF	MIN	MAC	BTE
4156	80	3-1/2	5-1/2	10
4157	84	3-3/4	5-3/4	10
4158	88	4	6	10
4159	96	4-1/2	6-1/2	10
4160	104	5	7	10
4161	116	5-3/4	7-3/4	
4162	128	6-1/2	8-1/2	
4163	152	8	10	
4164	164	8-3/4	10-3/4	
4165	188	10-1/4	12-1/4	
4166	200	11	13	
4167	212	11-3/4	13-3/4	
4168	224	12-1/2	14-1/2	
4169	236	13-1/4	15-1/4	
4170	248	14-3/4	16	
4171	270	15-3/8	17-3/8	
4172	312	18	20	
4173	390	22-7/8	24-7/8	

* Colliers Micro-Gear / Vis 1/4" hex. acier inoxydable 410 / Bande & Logement 5/16" acier inoxydable 201/301 / Micro-Gear Clamps / Screw 1/4" hex. stainless steel 410 / Band & housing 5/16" design Stainless steel 201/301

ASSORTIMENT / KIT

#ASF-2195

Comprend collet : 4, 6, 8, 10, 12, 16, 20, 24, 28, 32, 36, 40, (10 de chaque), Tiroir en métal / large metal drawer (120 mcx / pcs)



ASSORTIMENT / KIT

#ASF-097AI

Comprend collet : 4, 6, 10, 12, 16, 20, 24, 28, 32, 36, (10 de chaque) Support en métal / metal rack (100 mcx / pcs)



COLLIERS DE SERRAGE À PAROIE DOUBLE TRIDON®

INNER SHIELD CLAMPS TRIDON®

BANDE & LOGEMENT 1/2" ACIER INOXYDABLE 201/301 & VIS 5/16" HEX. ACIER PLAQUÉ ZINC
 BAND & HOUSING 1/2" STAINLESS STEEL 201/301 & SCREW 5/16" HEX. CARBON STEEL ZINC PLATED

INOX / ZINC



CODE	REF	MIN	MAX	BTE
4226*	4	1/4	5/8	10
4227*	6	5/8	7/8	10
4228	8	5/8	13/16	10
4229	10	9/16	1-1/16	10
4230	12	11/16	1-5/16	10
4231	16	3/4	1-1/2	10
4232	20	1-3/8	1-13/16	10
4233	24	1-1/2	2	10
4234	28	1-3/4	2-1/4	10

CODE	REF	MIN	MAX	BTE
4235	32	2	2-1/2	10
4236	36	1-13/16	2-3/4	10
4237	40	2-1/16	3-1/16	10
4238	44	2-5/16	3-1/4	10
4239	48	2-9/16	3-9/16	10
4253	52	2-13/16	3-3/4	10
4254	56	3-1/8	4-1/16	10
4257	60	3-5/16	4-1/4	10
4258	64	3-9/16	4-1/2	10

* Colliers Micro-Gear / Vis 1/4" hex. acier inoxydable 410 / Bande & Logement 5/16" acier inoxydable 201/301 / Micro-Gear Clamps / Screw 1/4" hex. stainless steel 410 / Band & housing 5/16" design Stainless steel 201/301

ASSORTIMENT / KIT

#ASF-2196

Comprend collet : 4, 6, 8, 10, 12, 16, 20, 24, 28, 32, 36, 40, 48, 52, 56, 60, 64 (10 de chaque) Coffre en métal / large metal case (170 mcx / pcs)



ASSORTIMENT / KIT

#ASF-2192

Comprend collet : 4, 6, 8, 10, 12, 16, 20, 24, 28, 32, 36, 40 (10 de chaque) Tiroir en métal / metal drawer (120 mcx / pcs)



COLLIERS DE SERRAGE "TORRO"

HOSE CLAMPS "TORRO"

BANDE & LOGEMENT - ACIER INOXYDABLE 430 / VIS 7MM. HEX. - ACIER PLAQUÉ JAUNE
 BAND & HOUSING - STAINLESS STEEL 430 / SCREW 7MM HEX. - STEEL YELLOW PLATED

INOX / ZINC



NUMÉRO PART NO.	REF	LARGEUR DE LA BANDE BAND WIDTH		RAYONS DE SERRAGE / TIGHTENING RANGE				BTE BOX
				MINIMUM		MAXIMUM		
		MM	POUCE / INCH	MM	POUCE / INCH	MM	POUCE / INCH	
3016508*	4	7,5MM	5/16"	8MM	1/2"	12MM	5/16"	10
10-16-762*	6	7,5MM	5/16"	10MM	5/8"	16MM	3/8"	10
3016516	4	9MM	3/8"	8MM	5/8"	16MM	5/16"	10
12-20-972	6	9MM	3/8"	12MM	3/4"	20MM	1/2"	10
16-25-972	8	9MM	3/8"	16MM	1"	25MM	5/8"	10
25-40-972	16	9MM	3/8"	25MM	1-5/8"	40MM	1"	10
30-45-972	20	9MM	3/8"	30MM	1-3/4"	45MM	1-3/16"	10
32-50-972	24	9MM	3/8"	32MM	2"	50MM	1-1/4"	10
40-60-972	28	9MM	3/8"	40MM	2-3/8"	60MM	1-5/8"	10
50-70-972	36	9MM	3/8"	50MM	2-3/4"	70MM	2"	10
60-80-972	40	9MM	3/8"	60MM	3-1/8"	80MM	2-3/8"	10
70-90-972	48	9MM	3/8"	70MM	3-1/2"	90MM	2-3/4"	10

TOURNEVIS POUR COLLIER DE SERRAGE DE TYPE "TORRO"

"TORRO" DRIVER WITH HEXAGONAL SOCKET HOSE CLAMP

POIGNÉE EN PLASTIQUE ROBUSTE - RÉSISTE AUX CHOCSEXENSION FLEXIBLE 10",
 FACILITE L'INSTALLATION AUX ENDROITS DIFFICILE. PRISE HEXAGONE - 1/4" & 5/16" OU 6MM & 7MM



#3387

COLLIERS DE SERRAGE MINIATURE TYPE "F.I."

TYPE "F.I." MINIATURE HOSE CLAMPS

BANDE 9MM - ACIER PLAQUÉ ZINC / VIS 7MM. HEX. - ACIER PLAQUÉ ZINC
 BAND 9MM - STEEL ZINC PLATED / SCREW 7MM HEX. - STEEL ZINC PLATED

ZINC / ZINC



NUMÉRO PART NO.	REF	BOYAUX HOSES	MIN	MAX	BTE BOX
6365A	3	5/32"	8mm 5/16"	10mm 7/16"	10
6365	4	1/4"	10.5mm 7/16"	13mm 1/2"	10
6366	6	5/16"	12.5mm 1/2"	15mm 9/16"	10
6367	8	3/8"	13.5mm 9/16"	16mm 5/8"	10

**IDÉAL POUR BOYAUX
 INJECTION À ESSENCE**
 • Collet pression 360°

**IDEAL FOR CASINGS
 GASOLINE INJECTION**
 • 360° pressure collar

COLLET POUR CÂBLE

WIRE TYPE CLAMP

ACIER / STEEL



NUMÉRO PART NO.	BOYAUX HOSES	BTE BOX
232-101	9/16"	50
232-102	5/8"	50
232-103	11/16"	50
232-104	3/4"	50
A17086	13/16"	50
232-107	15/16"	50
232-106	1"	50
A16598	1-1/4"	50
232-110	1-1/2"	25
A16603	1-7/8"	10
A16604	2"	10
A17078	2-1/8"	10

COLLET À TENSION CONSTANTE

CONSTANT TENSION BAND HOSE CLAMP
FOR HEATER & RADIATOR HOSES. 1074 SPRING STEEL
BLACK OEM FINISH. RATED AT 30 P.S.I.

LARGEUR DE LA BANDE
BAND WIDTH
15mm / 19/32"



NUMÉRO PART NO.	RAYON DE SERRAGE / TIGHTENING RANGE				BTE BOX
	MINIMUM		MAXIMUM		
	MM	POUCE/INCH	MM	POUCE/INCH	
A18127	15.2MM	5/8"	18.5MM	23/32"	10
A18128	17.8MM	23/32"	20.0MM	25/32"	10
A18129	22.0MM	7/8"	26.0MM	1"	10
A18132	37.2MM	1-15/32"	44.5MM	1-3/4"	10

COLLET À ACTION RESSORT

SPRING ACTION HOSE CLAMPS
ACIER SPRING STEEL, HEAT TREATED
PHOSPHATE AND PAINT



NUMÉRO PART NO.	BOYAUX/HOSE	COULEUR COLOR	AU REPOS NOT IN USE	LARGEUR WIDTH	BTE BOX
	EXT.		MAX.DIA.		
234-116	3/8	Black	.321	5/16	100
234-117	7/16	Green	.405	5/16	100
234-118	1/2	Red	.460	5/16	100
234-119	9/16	Black	.520	5/16	100
234-120	5/8	Olive	.583	5/16	100
234-121	11/16	Red	.655	5/16	100
234-122	3/4	Black	.645	3/8	100

COLLET À ADHÉRENCE UNIQUE

SINGLE BOND HOSE CLAMPS
NYLON NOIR / BLACK NYLON



NUMÉRO PART NO.	REF	RAYON DE SERRAGE / TIGHTENING RANGE		BTE BOX
		MIN	MAX	
A19558	1/4	.246	.290	25
A19559	5/16	.300	.350	25
A19560	11/32	.360	.406	25
A19562	15/32	.475	.536	25
A19564	19/32	.597	.665	25
A19566	3/4	.730	.830	25
A19568	61/64	.953	1.093	25
A195569	1-1/32	1.031	1.187	25

COLLIER DE SERRAGE TYPE "SUPRA"

"SUPRA" HOSE CLAMP

BANDE & LOGEMENT - ACIER INOXYDABLE 430 / VIS - ACIER PLAQUÉ JAUNE GR8.8
 BAND & HOUSING - STAINLESS STEEL 430 / SCREW - STEEL YELLOW PLATED GR8.8

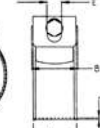
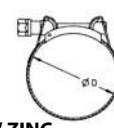
INOX / ZINC

NUMÉRO PART NO.	RAYON RANGE	POUCE INCH		FILET THREAD	DIMENSIONS				VALEUR MAXIMUM MAXIMUM		BTE BOX
	MM	MIN	MAX		E	A	B	S	SERRAGE TORQUE	PRESSION PRESSURE	
3019012	17-19	11/16	3/4	M6	8	18 ^{+0.2}	19.8	0.6	62	725	5
3019020	19-21	3/4	13/16							725	5
3019039	21-23	13/16	29/32							696	5
3019047	23-25	29/32	1							696	5
3019055	25-27	1	1-1/16							652	5
3019063	27-29	1-1/16	1-5/32							652	5
3019071	29-31	1-5/32	1-7/32							667	5
3019080	31-34	1-7/32	1-5/16	M7	10	20 ^{+0.3}	22	0.8 1.0	142	667	5
3019098	34-37	1-5/16	1-7/16							667	5
3019100	37-40	1-7/16	1-9/16							638	5
3019119	40-43	1-9/16	1-11/16							638	5
3019127	43-47	1-11/16	1-27/32							638	5
3019135	47-51	1-27/32	2							638	5
3019143	51-55	2	2-5/32							580	5
3019151	55-59	2-5/32	2-5/16							580	5
3019160	59-63	2-5/16	2-15/32							522	5
3019178	63-68	2-15/32	2-11/16							522	5
3019186*	68-73	2-11/16	2-7/8	M8	13	25 ^{+0.4}	27.5	1.2	221	406	1
3019194*	73-79	2-7/8	3-3/32							406	1
3019207*	79-85	3-3/32	3-5/16							290	1
3019215*	85-91	3-5/16	3-9/16							290	1
3019223*	91-97	3-9/16	3-13/16							290	1
3019231*	97-104	3-13/16	4-3/32							290	1
3019240*	104-112	4-3/32	4-3/8							174	1
3019258*	112-121	4-3/8	4-3/4							174	1
3019266*	121-130	4-3/4	5/1/8							174	1
3019274	130-140	5-1/8	5-1/2							131	1
3019282	140-150	5-1/2	5-7/8	M10	15	28 ^{+0.4}	31	1.5	443	131	1
3019290	150-162	5-7/8	6-3/8							131	1
3019303	162-174	6-3/8	6-7/8							87	1
3019311	174-187	6-7/8	7-3/8							87	1
3019320	187-200	7-3/8	7-7/8							87	1
3019338	200-213	7-7/8	8-3/8							44	1
3019346	213-226	8-3/8	8-7/8							44	1
3019354	226-239	8-7/8	9-3/8							44	1
3019362	239-252	9-3/8	9-7/8							44	1
3019370	252-265	9-15/16	10-27/32							44	1

(1) Nous recommandons de travailler à 75% de la valeur maximum / We recommend working at 75% of the maximum values.

25-07-2024

COLLIER DE SERRAGE TYPE "SUPRA" "SUPRA" HOSE CLAMP

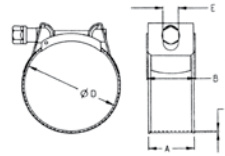

BANDE & LOGEMENT - ACIER INOXYDABLE 304 / VIS - ACIER INOXYDABLE 304
BAND & HOUSING - STAINLESS STEEL 304 / SCREW - STAINLESS STEEL 304

INOX / INOX

NUMÉRO PART NO.	RAYON RANGE	POUCE INCH		FILET THREAD	DIMENSIONS				VALEUR MAXIMUM MAXIMUM		BTE BOX
	MM	MIN	MAX		E	A	B	S	SERRAGE TORQUE	PRESSION PRESSURE	
3013016	17-19	11/16	3/4	M6	8	18 ^{+0.2}	19.8	0.6	62	725	1
3013024	19-21	3/4	13/16							725	1
3013032	21-23	13/16	29/32							696	1
3013040	23-25	29/32	1							696	1
3013059	25-27	1	1-1/16							652	1
3013067	27-29	1-1/16	1-5/32							652	1
3013075	29-31	1-5/32	1-7/32							667	1
3013083	31-34	1-7/32	1-5/16	M7	10	20 ^{+0.3}	22	0.8 1.0	142	667	1
3013091	34-37	1-5/16	1-7/16							667	1
3013104	37-40	1-7/16	1-9/16							638	1
3013112	40-43	1-9/16	1-11/16							638	1
3013120	43-47	1-11/16	1-27/32							638	1
3013139	47-51	1-27/32	2							638	1
3013147	51-55	2	2-5/32							580	1
3013155	55-59	2-5/32	2-5/16	580	1						
3013163	59-63	2-5/16	2-15/32	522	1						
3013171	63-68	2-15/32	2-11/16	522	1						
3013180	68-73	2-11/16	2-7/8	406	1						
3013198	73-79	2-7/8	3-3/32	M8	13	25 ^{+0.4}	27.5	1.2	221	406	1
3013200	79-85	3-3/32	3-5/16							406	1
3013219	85-91	3-5/16	3-9/16							290	1
3013227	91-97	3-9/16	3-13/16							290	1
3013235	97-104	3-13/16	4-3/32							290	1
3013243	104-112	4-3/32	4-3/8							174	1
3013251	112-121	4-3/8	4-3/4							174	1
3013260	121-130	4-3/4	5/1/8	174	1						
3013278	130-140	5-1/8	5-1/2	131	1						
3013286	140-150	5-1/2	5-7/8	M10	15	28 ^{+0.4}	31	1.5	443	131	1
3013294	150-162	5-7/8	6-3/8							131	1
3013307	162-174	6-3/8	6-7/8							87	1
3013315	174-187	6-7/8	7-3/8							87	1
3013323	187-200	7-3/8	7-7/8							87	1
3013331	200-213	7-7/8	8-3/8							44	1
3013340	213-226	8-3/8	8-7/8							44	1
3013358	226-239	8-7/8	9-3/8	44	1						
3013366	239-252	9-3/8	9-7/8	44	1						
3013377	252-265	9-15/16	10-27/32	44	1						

(1) Nous recommandons de travailler à 75% de la valeur maximum / We recommend working at 75% of the maximum values.

COLLIER DE SERRAGE ROBUSTE FLEX-GEAR HD® / FLEX-GEAR HD® CLAMPS 45 SERIES HEAVY DUTY

Muni d'un ressort Belleville pour éviter toute fuite, le collier Flex-Gear HD® s'ajuste au tuyau et à la pièce pour maintenir une tension constante sur le branchement. Excellent choix pour les applications sous des températures extrêmes et fluctuantes et pour la compensation thermique. Tête à six pans de 9,525 mm et bande de 15,875 mm de large. Vis en acier inoxydable série 410.

Using a Belleville spring design to eliminate «cold flow» leakage, Flex-Gear HD® clamps adjust with the hose and fitting to maintain constant tension on the connection. Excellent choice for fluctuating and extreme temperature applications and thermal compensation. 3/8" hex head and 5/8" band width. 410 stainless steel screws.



FLEX-GEAR®	DIAGRAMME DES TAILLES/PLAGES DE SERRAGE				POUR TUYAUX DIAMETRE	
	NO DE PIÈCE	MIN. (PO.)	MAX. (PO.)	MIN. (MM)	MAX. (MM)	MIN. (PO.)
491-45175	1	1-3/4	25	45	7/8	1- 1/8
491-45200	1-1/4	2-1/8	32	54	1	1-1/2
491-45250	1-3/4	2-5/8	45	67	1-1/2	2
491-45300	2-1/4	3-1/8	57	79	2	2-1/2
491-45350	2-3/4	3-5/8	70	92	2-1/2	3
491-45400	3-1/4	4-1/8	83	105	3	3-1/2
491-45450	3-3/4	4-5/8	95	117	3-1/2	4
491-45500	4-1/4	5-1/8	108	130	4	4-1/2
491-45550	4-3/4	5-5/8	121	143	4-1/2	5
491-45600	5-1/4	6-1/8	133	155	5	5-1/2

Autres dimensions disponibles sur demande.

Caractéristiques des matériaux

- Ressort Belleville de plus gros calibre usiné avec précision
- Vis : tête à six pans de 7,9248 mm. Acier inoxydable série 410.
- Bande : largeur de bande de 12,7 mm. Acier inoxydable série 300.
- Garniture : acier inoxydable série 300.
- Logement : acier inoxydable série 300.
- Ressorts : acier inoxydable série 300.

Material Specifications

- Larger, heavier gauge and precision formed Belleville springs
- Screw: 3/8" hex-head. 410 stainless steel.
- Band: 5/8" band width. 300 grade stainless steel.
- Liner: 300 grade stainless steel.
- Housing: 300 grade stainless steel.
- Springs: 300 grade stainless steel.

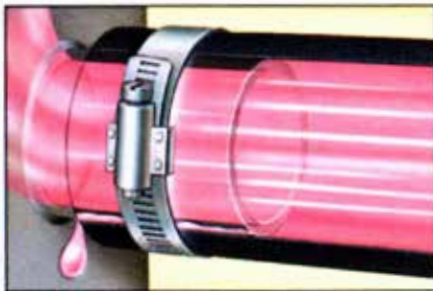

Les colliers réguliers ne s'ajustent pas lors des températures extrêmes de chaleur et cause des fuites.

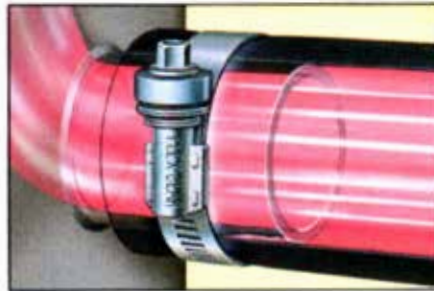

Les colliers Flex-gear® à tension constante, s'ajustent aux variantes de températures extrêmes de chaleur et éliminent les fuites.

dimension 33-3/4"Large (W) x 11-5/8"Profond (D) x 7-3/8"Hauteur (H)



#ASF-800 Assortiment de colliers Flex-Gear®

Qté / Qty : 23 Pièces / Pieces Tiror / Draw HD12 Cases / Bin

NO.	QTE / QTY	NO.	QTE / QTY
491-45175	3	491-45400	2
491-45200	3	491-45450	2
491-45250	3	491-45500	2
491-45300	3	491-45550	1
491-45350	2	491-45600	1
CABINET HD12 #260-HD12			1

25-07-2024

COLLIER DE SERRAGE "SUPRA CT TENSION CONSTANTE" "CONSTANT TENSION CLAMPS SUPRA CT"



INOX / ZINC



BANDE & LOGEMENT - ACIER INOXYDABLE 304 / VIS - ACIER / BAND & HOUSING - STAINLESS STEEL 304 / SCREW - STEEL

NUMÉRO PART NO.	RAYON RANGE	POUCE INCH		FILET THREAD	DIMENSIONS				VALEUR MAXIMUM MAXIMUM		BTE BOX						
	MM	MIN	MAX		E	A	B	S	SERRAGE TORQUE	PRESSION PRESSURE							
6278071	17-19	11/16	3/4	M6	8	18 ^{+0.2}	19.8	0.6	62	725	1						
6278079	19-21	3/4	13/16							725	1						
6278087	21-23	13/16	29/32							696	1						
6278094	23-25	29/32	1							696	1						
6278102	25-27	1	1-1/16							652	1						
6278110	27-29	1-1/16	1-5/32							652	1						
6278118	29-31	1-5/32	1-7/32							667	1						
6278128	31-34	1-7/32	1-5/16							667	1						
6278140	34-37	1-5/16	1-7/16							667	1						
6278152	37-40	1-7/16	1-9/16							638	1						
6278163	40-43	1-9/16	1-11/16							638	1						
6278175	43-47	1-11/16	1-27/32							M7	10	20 ^{+0.3}	22	0.8 / 1.0	142	638	1
6278192	47-51	1-27/32	2	638	1												
6278208	51-55	2	2-5/32	580	1												
6278225	55-59	2-5/32	2-5/16	580	1												
6278240	59-63	2-5/16	2-15/32	522	1												
6278260	63-68	2-15/32	2-11/16	522	1												
6278275*	68-73	2-11/16	2-7/8	406	1												
6278300*	73-79	2-7/8	3-3/32	406	1												
6278325*	79-85	3-3/32	3-5/16	406	1												
6278350*	85-91	3-5/16	3-9/16	290	1												
6278375*	91-97	3-9/16	3-13/16	290	1												
6278400*	97-104	3-13/16	4-3/32	290	1												
6278425*	104-112	4-3/32	4-3/8	M8	13	25 ^{+0.4}	27.5	1.2	221	174	1						
6278450*	112-121	4-3/8	4-3/4							174	1						
6278500*	121-130	4-3/4	5/1/8							174	1						
6278525	130-140	5-1/8	5-1/2							131	1						
6278575	140-150	5-1/2	5-7/8							131	1						
6278600	150-162	5-7/8	6-3/8							131	1						
6278650	162-174	6-3/8	6-7/8							87	1						
6278700	174-187	6-7/8	7-3/8							87	1						
6278750	187-200	7-3/8	7-7/8							87	1						
6278800	200-213	7-7/8	8-3/8							M10	15	28 ^{+0.4}	31	1.5	443	44	1
6278850	213-226	8-3/8	8-7/8													44	1
6278900	226-239	8-7/8	9-3/8													44	1
6278950	239-252	9-3/8	9-7/8														
62781000	252-265	9-15/16	10-27/32														
62781050	265-278	10-7/16	10-29/32														
62781275	317-330	12-7/16	13														

COLLIERS DE SERRAGE "FLEX SEAL" ULTRA RÉSISTANT FLEX SEAL CLAMPS HEAVY DUTY

BANDE ACIER INOXIDABLE. BOULON ET LOGEMENT EN ACIER
STAINLESS STEEL BAND. CARBONNE STEEL BOLT & HOUSING



NUMÉRO PART NO.	MIN	MAX	BTE BOX
597-HC19-225	2	2-5/16	
597-HC19-238	2-3/16	2-1/2	
597-HC19-250	2-5/16	2-5/8	
597-HC19-263	2-3/8	2-11/16	
597-HC19-270	2-7/16	2-3/4	
597-HC19-275	2-9/16	2-7/8	
597-HC19-288	2-11/16	3	
597-HC19-300	2-13/16	3-1/8	
597-HC19-312	2-15/16	3-1/4	
597-HC19-325	3	3-3/8	
597-HC19-350	3-5/16	3-5/8	
597-HC19-375	3-9/16	3-7/8	
597-HC19-382	3-5/8	3-15/16	
597-HC19-412	3-13/16	4-1/8	
597-HC19-425	4	4-3/8	
597-HC19-450	4-5/16	4-5/8	
597-HC19-475	4-9/16	4-7/8	
597-HC19-500	4-13/16	5-1/8	
597-HC19-525	5	5-3/8	
597-HC19-550	5-5/16	5-5/8	
597-HC19-575	5-9/16	5-7/8	
597-HC19-600	5-13/16	6-1/8	

COLLET À 1 OREILLE

1 - EAR CLAMPS

PLAQUÉ ZINC / ZINC PLATED

APPLICATION:

SPÉCIALEMENT CONÇU POUR LES APPLICATIONS À BASSE PRESSION .
AUTOMOTIVE, MACHINERIE, ÉQUIPEMENT DIVERS. UTILISEZ POUR LA PRODUCTION MASSIVE.

APPLICATION:

SPECIALLY DESIGNED FOR LOW PRESSURE APPLICATIONS. AUTOMOTIVE, MACHINERY, MISCELLANEOUS
EQUIPMENT. USE FOR MASSIVE PRODUCTION.

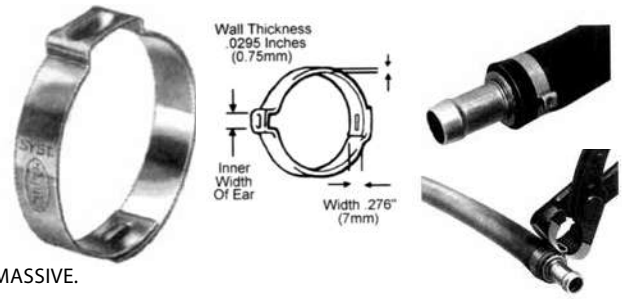

NUMÉRO PART NO.	DIMENSION	FERMÉ CLOSE	OUVERT OPEN	BTE BOX
DHC8-6	3/8	.343	.414	25
DHC8-7	7/16	.381	.444	25
DHC8-7-1/2	15/32	.394	.486	25
DHC8-8	1/2	.453	.524	25
DHC8-8-1/2	35/64	.472	.551	25
DHC8-9	9/16	.496	.571	25
DHC8-10	5/8	.543	.618	25
DHC8-11	11/16	.594	.669	25
DHC8-11-1/2	23/32	.618	.728	25
DHC8-12	3/4	.669	.779	25
DHC8-13	13/16	.716	.827	25
DHC8-14	7/8	.779	.890	25
DHC8-15	15/16	.839	.949	25
DHC8-16	1	.898	1.008	25
DHC8-17	1-1/16	.945	1.067	25
DHC8-18	1-1/8	1.004	1.126	25
DHC8-19	1-3/16	1.063	1.185	25
DHC8-20	1-1/4	1.122	1.244	25
DHC8-21	1-5/16	1.181	1.303	25
DHC8-22	1-3/8	1.240	1.362	25
DHC8-23	1-7/16	1.299	1.421	25
DHC8-23-1/2	1-15/32	1.358	1.480	25
DHC8-24	1-1/2	1.378	1.500	10
DHC8-25	1-9/16	1.437	1.559	10
DHC8-26	1-5/8	1.492	1.614	10
DHC8-27	1-11/16	1.551	1.673	10
DHC8-27-1/2	1-23/32	1.610	1.732	10

NUMÉRO PART NO.	DIMENSION	FERMÉ CLOSE	OUVERT OPEN	BTE BOX
DHC8-28	1-3/4	1.669	1.791	10
DHC8-29	1-13/16	1.728	1.850	10
DHC8-30	1-7/8	1.787	1.909	10
DHC8-31	1-15/16	1.846	1.968	10
DHC8-32	2	1.905	2.028	10
DHC8-33	2-1/16	1.965	2.087	10
DHC8-34	2-1/8	2.024	2.146	10
DHC8-35	2-3/16	2.083	2.205	10
DHC8-36	2-1/4	2.142	2.264	10
DHC8-37	2-5/16	2.201	2.323	10
DHC8-38	2-3/8	2.260	2.382	10
DHC8-39	2-7/16	2.319	2.441	10
DHC8-40	2-1/2	2.378	2.500	10
DHC8-41	2-9/16	2.437	2.559	10
DHC8-42	5-5/8	2.496	2.618	10
DHC8-43	2-11/16	2.555	2.677	10
DHC8-43-1/2	2-23/32	2.614	2.736	10
DHC8-44	2-3/4	2.673	2.795	10
DHC8-45	2-13/16	2.732	2.854	10
DHC8-46	2-7/8	2.791	2.913	10
DHC8-47	2-15/16	2.850	2.972	10
DHC8-48	3	2.909	3.031	10
DHC8-49	3-1/16	2.968	3.090	10
DHC8-50	3-1/8	3.028	3.150	10
DHC8-51	3-3/16	3.087	3.209	10
DHC8-52	3-1/4	3.146	3.268	10

* Produit inclus dans le coffre assortiment ASF- 203 / product include if ear clamps kit #ASF-203

COLLET 2 OREILLES

2 - EAR CLAMPSS

PLAQUÉ ZINC / ZINC PLATED

APPLICATION:

CONÇU POUR LES APPLICATIONS À PRESSION INTERMÉDIAIRE. POUR MAINTENANCE INDUSTRIELLE.
UTILISEZ POUR CONDUIT D'AIR, LIQUIDE, GAZ ET VAPEUR.

APPLICATION:

DESIGNED FOR INTERMEDIATE PRESSURE APPLICATIONS. FOR INDUSTRIAL MAINTENANCE.
USE FOR AIR DUCT, LIQUID, GAS AND STEAM.



NUMÉRO PART NO.	DIMENSION	REF OETIKER	FERMÉ CLOSE	OUVERT OPEN	BTE BOX
DHC9-2-1/2	5/32	4.10	.122	.161	25
DHC9-2-3/4	11/64	4.35	.138	.177	25
DHC9-3	3/16	6	.118	.197	25
DHC9-4	1/4	7	.197	.276	25
DHC9-5	5/16	9	.276	.354	25
DHC9-6	3/8	11	.315	.433	25
DHC9-7	7/16	12	.354	.433	25
DHC9-8	1/2	13	.433	.512	25
DHC9-9	9/16	15	.512	.591	25
DHC9-9-1/2	19/32	17	.591	.669	25
DHC9-10	5/8	18	.591	.708	25
DHC9-12	3/4	20	.669	.787	25

NUMÉRO PART NO.	DIMENSION	REF OETIKER	FERMÉ CLOSE	OUVERT OPEN	BTE BOX
DHC9-13	13/16	22	.748	.866	25
DHC9-14	7/8	23	.787	.905	25
DHC9-15	15/16	25	.866	.984	25
DHC9-16	1	27	.905	1.063	25
DHC9-17	1-1/16	28	.984	1.102	25
DHC9-18	1-1/8	31	1.063	1.220	25
DHC9-19	1-3/16		1.102	1.220	25
DHC9-21	1-5/16	34	1.220	1.339	25
DHC9-23	1-7/16	37	1.339	1.457	25
DHC9-24	1-1/2	40	1.457	1.575	25
DHC9-26	1-5/8	43	1.575	1.693	10
DHC9-28	1-3/4	46	1.693	1.811	10

OUTILS POUR COLLET

EAR CLAMPS TOOL

PINCE LATÉRALE
SIDE CRIMPER
#DHC9-S



PINCE ROBUSTE DROITE
HEAVY DUTY STRAIGHT
CRIMPER
#DHC9-RHD



ASSORTIMENT DE COLLET À OREILLES

EAR CLAMPS KIT

COFFRE EN MÉTAL COMPREND:
20 GRANDEURS + PINCE #DHC9-RHD

LARGE METAL CASE INCLUDE:
20 SIZES + CRIMPER #DHC9-RHD

#ASF-203



* Voir liste des produit avec étoile inclus dans le coffre
* Product list include if ear clamps kit

COLLET ACIER PLAQUÉ RECOUVERT DE NÉOPRENE

STEEL PLATED NEOPRENE CABLE CLAMP

ACIER PLAQUÉ ZINC / ZINC PLATED

TROU / HOLE
3/8"



NUMÉRO PART NO.	NUMÉRO INOX. PART NO. INOX	FERMÉ CLOSE	MIN.	MAX.	SAE	BTE BOX
D17-4-38	D17-4-38AI	1/4	3/16	1/4	4	25
D17-6-38	D17-6-38AI	3/8	1/4	3/8	6	25
D17-8-38	D17-8-38AI	1/2	3/8	1/2	8	25
D17-10-38	D17-10-38AI	5/8	1/2	5/8	10	25
D17-12-38	D17-12-38AI	3/4	5/8	3/4	12	25
D17-14-38	D17-14-38AI	7/8	3/4	7/8	14	25
D17-16-38	D17-16-38AI	1	7/8	1	16	25

NUMÉRO PART NO.	NUMÉRO INOX. PART NO. INOX	FERMÉ CLOSE	MIN.	MAX.	SAE	BTE BOX
D17-18-38	D17-18-38AI	1-1/8	1	1-1/8	18	10
D17-20-38	D17-20-38AI	1-1/4	1-1/8	1-1/4	020	10
D17-24-38	D17-24-38AI	1-1/2	1-3/8	1-1/2	024	10
*D17-26-38	*D17-26-38AI	1-5/8	1-1/2	1-5/8	026	10
*D17-28-38	*D17-28-38AI	1-3/4	1-5/8	1-3/4	028	10
*D17-30-38	*D17-30-38AI	1-7/8	1-3/4	1-7/8	030	10
*D17-32-38	*D17-32-38AI	2	1-7/8	2	032	10
D17-40-38	D17-40-38AI	2-1/2				



#ASF-204 ASSORTIMENT / KIT

Comprend tous les collets (15 grandeurs / 10 de chaque) / Includes all clamps (15 sizes / 10 of each)
Tiroir en métal / metal drawer
150 mcx / pcs

* = PLAQUÉ JAUNE / YELLOW PLATED

COLLIER ACIER PLAQUÉ RECOUVERT DE NÉOPRENE

STEEL PLATED NEOPRENE CABLE CLAMP

ACIER PLAQUÉ / PLATED STEEL

TROU / HOLE
1/4"



NUMÉRO PART NO.	FERMÉ CLOSE	MIN.	MAX.	SAE	BTE BOX
D17-4	1/4	3/16	1/4	4	25
D17-6	3/8	1/4	3/8	6	25
D17-8	1/2	3/8	1/2	8	25
D17-10	5/8	1/2	5/8	10	25
D17-12	3/4	5/8	3/4	12	25
D17-14	7/8	3/4	7/8	14	25
D17-16	1	7/8	1	16	25
D17-18	1-1/8	1	1-1/8	18	10
D17-20	1-1/4	1-1/8	1-1/4	20	10
D17-22	1-3/8	1-1/4	1-3/8	22	10
D17-24	1-1/2	1-3/8	1-1/2	24	10
D17-26	1-5/8	1-1/2	1-5/8	26	10
D17-28	1-3/4	1-5/8	1-3/4	28	10
D17-30	1-7/8	1-3/4	1-7/8	30	10
D17-32	2	1-7/8	2	32	10
D17-34	2-1/8	2	2-1/8	34	10
D17-36	2-1/4	2-1/8	2-1/4	36	10
D17-38	2-3/8	2-1/4	2-3/8	38	10
D17-40	2-1/2	2-3/8	2-1/2	40	10
D17-48	3	2-7/8	3	48	10
D17-56	3-1/2	3-3/8	3-1/2	56	10
D17-64	4	3-7/8	4	64	10

COLLIER RECOUVERT DE NÉOPRENE

LOOM CLAMPS

ACIER INOXYDABLE 18-8
STAINLESS STEEL 18-8



TROU / HOLE
1/4"

NUMÉRO PART NO.	FERMÉ CLOSE	MIN.	MAX.	SAE	BTE BOX
D17-4AI	1/4	3/16	1/4	004	10
D17-6AI	3/8	1/4	3/8	006	10
D17-8AI	1/2	3/8	1/2	008	10
D17-10AI	5/8	1/2	5/8	010	10
D17-12AI	3/4	5/8	3/4	012	10
D17-14AI	7/8	3/4	7/8	014	10
D17-16AI	1	7/8	1	016	10
D17-18AI	1-1/8	1	1-1/8	018	10
D17-20AI	1-1/4	1-1/8	1-1/4	020	10
D17-22AI	1-3/8	1-1/4	1-3/8	022	10
D17-24AI	1-1/2	1-3/8	1-1/2	024	10
D17-26AI	1-5/8	1-1/2	1-5/8	026	10
D17-28AI	1-3/4	1-5/8	1-3/4	028	10
D17-30AI	1-7/8	1-3/4	1-7/8	030	10
D17-32AI	2	1-7/8	2	032	10
D17-40AI	2-1/2	2-3/8	2-1/2	040	10
D17-48AI	3	2-7/8	3	048	10

COLLET FERMÉ INSULÉ

STEEL INSULATED CLOSED CLAMPS

• ACIER GALVANIZÉ RECOUVERT DE VINYL NOIR (1/32" ÉPAIS) / • GALVANIZED COATED WITH BLACK VINYL (1/32" THICK)

TROU/HOLE 9/32"

NUMÉRO PART NO.	DIAM.INT INT.DIAM.	LARGEUR WIDTH	CALIBRE CALIBER	BTE BOX
234-157	3/16	1/2	.032	25
234-134	1/4	1/2	.032	25
234-135	5/16	1/2	.032	25
234-136	3/8	1/2	.048	25
234-137	1/2	1/2	.048	25
234-138	5/8	1/2	.048	25
234-139	3/4	1/2	.048	25
234-140	7/8	1/2	.048	25
234-141	1	1/2	.048	25
234-142	1/4	3/4	.032	25



TROU/HOLE 16/32"

NUMÉRO PART NO.	DIAM.INT INT.DIAM.	LARGEUR WIDTH	CALIBRE CALIBER	BTE BOX
234-143	5/16	3/4	.032	25
234-144	3/8	3/4	.032	25
234-145	1/2	3/4	.048	25
234-146	5/8	3/4	.048	25
234-147	3/4	3/4	.048	25
234-148	7/8	3/4	.048	25
234-149	1	3/4	.048	25
234-150	1-1/4	3/4	.048	25
234-151	1-1/2	3/4	.048	25
A17588	1-3/4	3/4	.048	10
A17589	2	3/4	.048	10

COLLET DEMIE INSULÉ

STEEL INSULATED HALF CLAMPS

• ACIER GALVANIZÉ RECOUVERT DE VINYL NOIR (1/32" ÉPAIS)

• GALVANIZED COATED WITH BLACK VINYL (1/32" THICK)



TROU/HOLE 7/32"

NUMÉRO PART NO.	DIAM.INT INT.DIAM.	LARGEUR WIDTH	CALIBRE CALIBER	BTE BOX
234-126	3/16	1/2	.032	25
234-127	1/4	1/2	.048	25

COLLET ALUMINIUM POUR TUYAUX

ALUMINUM TUBING CLAMPS

• ALUMINIUM RECOUVERT DE VINYL PVC

• VINYL PVC DIPPED ALUMINUM



TROU/HOLE 5/32"

NUMÉRO	TUYAU DIAM.	LARGE	BTE
234-108	1/4	3/8	15
234-109	5/16	3/8	15
234-110	3/8	3/8	15
234-111	1/2	3/8	15
234-112	5/8	3/8	15
234-113	3/4	1/2	15
234-114	7/8	1/2	15
234-115	1	1/2	15

TROU/HOLE 9/32"

NUMÉRO PART NO.	DIAM.INT INT.DIAM.	LARGEUR WIDTH	CALIBRE CALIBER	BTE BOX
234-128	5/16	5/8	.048	25
234-129	3/8	5/8	.048	25
234-130	7/16	5/8	.060	25
234-131	1/2	5/8	.060	25
234-132	5/8	5/8	.060	25
234-133	3/4	5/8	.060	25

COLLET FERMÉ NON - INSULÉ

STEEL UNINSULATED CLOSED CLAMPS

• ACIER GALVANIZÉ / GALVANIZED



TROU/HOLE 9/32"

NUMÉRO PART NO.	DIAM.INT INT.DIAM.	LARGEUR WIDTH	CALIBRE CALIBER	BTE BOX
234-152	1/4	1/2	.032	25
234-153	3/8	1/2	.032	25
234-154	1/2	1/2	.048	25
234-155	3/4	1/2	.048	25

COLLET NYLON POUR TUYAUX

NYLON TUBING CLAMPS

NUMÉRO PART NO.	NUMÉRO NOIR PART NO. BALCK.	LARGEUR WIDTH	CALIBRE CALIBER	BTE BOX
A15525	A15525B	3/8	1/8	50
A15526	A15526B	3/8	3/16	50
234-101	234-101B	3/8	1/4	25
234-102	234-102B	3/8	5/16	25
234-103	234-103B	3/8	3/8	25
234-104	234-104B	3/8	1/2	25
234-105	234-105B	1/2	5/8	25
234-106	234-106B	1/2	3/4	25
234-107	234-107B	1/2	1	25
234-158	234-158B	1/2	1-1/2	25



TROU/HOLE 3/16"

• NYLON NATUREL / NATURAL NYLON
• NYLON NOIR / BLACK NYLON

COLLET POUR TUYAUX

TUBE CLAMPS DUPLEX

• ACIER PLAQUÉ ZINC
• STEEL ZINC PLATED



NUMÉRO	TUYAU DIAM.	LARGE	BTE
D19-22	1/8	1/8	25
D19-44	1/4	1/4	25
D19-66	3/8	3/8	25
D19-88	1/2	1/2	25
D19-1010	5/8	5/8	25
D19-46	1/4	3/8	25
D19-610	3/8	5/8	25

COLLET POUR TUYAUX

TUBE CLAMPS

• ACIER PLAQUÉ CUIVRE
• STEEL COOPER COATED



NUMÉRO	TUYAU DIAM.	BTE
D14-6	3/8	100
D14-8	1/2	100
D14-10	5/8	100
D14-14	7/8	100
D14-18	1-1/8	100
D14-22	1-3/8	100
D14-26	1-5/8	100

COLLET POUR TUYAUX - ROBUSTE

TUBE CLAMPS - HEAVY

• ACIER PLAQUÉ ZINC
• STEEL ZINC PLATED



NUMÉRO	TUYAU DIAM.	LARGE	BTE
D20-2	1/8	100	25
D20-3	3/16	100	25
D20-4	1/4	100	25
D20-5	5/16	100	25
D20-6	3/8	100	25
D20-8	1/2	100	25
D20-10	5/8	100	25
D20-12	3/4	100	25
D20-16	1	100	25

COLLET POUR TUYAUX - ROBUSTE

TUBE CLAMPS - HEAVY

• CUIVRE / COOPER



NUMÉRO	TUYAU DIAM.	LARGE	BTE
D21-2	1/8	1/2	50
D21-3	3/16	1/2	50
D21-4	1/4	1/2	50
D21-5	5/16	1/2	50
D21-6	3/8	5/8	50
D21-8	1/2	5/8	50
D21-10	5/8	3/8	50
D21-12	3/4	3/4	50
D21-16	1	7/8	50

ATTACHES POUR CÂBLE

WIRE LOOM CLIPS

GRANDEUR RÉELLE / ACTUAL SIZE

APPLICATION POUR HAUTE TEMPÉRATURE
FOR UNDERHOOD OR HIGH HEAT APPLICATIONS



18-101
A18101

Phosphate

Wire Loom Clips
With Vinyl (PVC) Cushion
Truck Body Frame

UNIT PACKAGE: 25



18-102

Phosphate

Wire Loom Clips
With Vinyl (PVC) Cushion
Truck Body Frame

UNIT PACKAGE: 25



18-103

Phosphate
Wire Loom Clips
With Vinyl (PVC) Cushion
Truck Body Frame

UNIT PACKAGE: 25



18-105
A18105

Phosphate

Wire Loom Clips
With Vinyl (PVC) Cushion
Truck Body Frame

UNIT PACKAGE: 25



18-110

Wire Loom Clips
Clamps two 3/16" wires

UNIT PACKAGE: 100



18-107

Wire Loom Clips
1/4" Clamping Dia.

UNIT PACKAGE: 100



18-108

Wire Loom Clips
3/16" Clamping Dia.

UNIT PACKAGE: 100

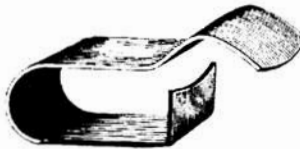

18-109

Wire Loom Clips
3/8" Clamping Dia.

UNIT PACKAGE: 100



18-106

Wire Loom Clips
All Cars - All Models

UNIT PACKAGE: 100



18-114
A14388
(145525)

Heavy Duty Frame Wiring Clip
3/16" Clamping Diameter
Fits panels from .030"-.230"

UNIT PACKAGE: 50

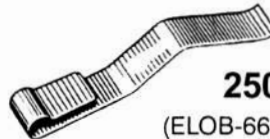

250-186

(ELOB-66454A30-AA)

Wire Harness Retainer Clip
Ford 1980-On

UNIT PACKAGE: 25



18-111

Wire Loom Clips
All Cars - All Models

UNIT PACKAGE: 50



18-112

(372741-S100)
General Purpose Wire Loom Clip

UNIT PACKAGE: 100

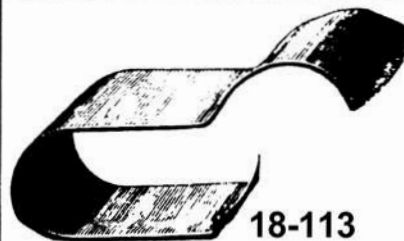

18-113

(373415)

General Purpose Wire Loom Clip

UNIT PACKAGE: 100

COLLET ROTATIF POUR CÂBLE

WIRE LOOM ROUTING CLIPS

NYLON NOIR / BLACK NYLON

RAPIDE ET MÉTHODE ÉCONOMIQUE POUR FIXER LA PLUPART DES CÂBLE, TUBES, BOYAUX ET PROTÈGE FILS.
A QUICK, ECONOMICAL METHOD OF FASTENING WIRES, TUBES, HOSES OR RODS.



NUMÉRO PART NO.	TYPE	DIMENSION I.D.	DIMENSION O.D.	# GM	BTE BOX
249-1003	3	1/4"	3/8	12040984	15
A19795	4	1/4"	3/8	12015631	15
249-693	1	11/32"	1/2	8911473	25
A20397*	6	10MM	13MM	12160858	15
A20471	4	10MM	13MM	8905794	15
A14545	1	13/32"	19/32	8911497	25
249-409	1	1/2"	11/16	8911472	25
A19851	5	1/2"	11/16	12040983	15
249-497	1	3/4"	1	3816659, 8917320	25
A20665	7	19MM	24MM	12160374	15
249-969	2	1"	1-9/32	12015983	25

* NYLON GRIS / GRAY NYLON



NUMÉRO PART NO.	DIAM. FILS STRING DIAM.	DIM. TUYAU I.D. I.D. HOSE DIM.	DIM. TUYAU O.D. O.D. HOSE DIM.	BTE BOX
A14529	1/4"	27/32	7/16"	25
A14530	3/8"	29/32"	15/32"	25
A14531	1/2"	1-1/16"	5/8"	25
A14532	5/8"	1-3/16"	3/4"	25
A14533	3/4"	1-5/16"	7/8"	25
A14534	1"	1-19/32"	1-5/32	25



BAND-IT®, LA SOLUTION...

UTILISEZ POUR ATTACHER CONDUITS ÉLECTRIQUES, BOÎTES DE SYSTÈME D'ALARME, CÂBLES DE TOUS GENRES. IDÉAL POUR FIXER BOÎTES DE CONTRÔLE ET PANNEAUX DE SIGNALISATION.

BAND-IT®, THE SOLUTION ...

USE TO ATTACH ELECTRICAL CONDUITS, SYSTEM BOXES ALARM, CABLES OF ALL KINDS. IDEAL FOR SECURING BOXES OF CONTROL AND SIGNS.

BANDE BAND-IT® BAND-IT® BAND

ACIER INOXYDABLE TYPE 201 / 100 PIEDS / ROULEAU		
NUMÉRO	TUYAU DIAM.	LARGE
#C203	3/8" LARGE	.025" EPAIS
#C204	1/2" LARGE	.030" EPAIS
#C206	3/4" LARGE	.030" EPAIS

ACIER INOXYDABLE 316 / 100 PIEDS / ROULEAU		
NUMÉRO	TUYAU DIAM.	LARGE
#C404	1/2" LARGE	.030" EPAIS
#C406	3/4" LARGE	.030" EPAIS

VALUSTRAP BAND-IT® BAND-IT® VALUSTRAP

ACIER INOXYDABLE NON-MAGNÉTIQUE / 100 PIEDS / ROULEAU		
NUMÉRO	TUYAU DIAM.	LARGE
#C134	1/2" LARGE	.015"-.017" EPAIS
#C136	3/4" LARGE	.015"-.017" EPAIS



1 Band may be used from bulk roll as this completely eliminates waste of band. Slide buckle on band as shown, bringing end of band around object to be clamped and again through buckle.

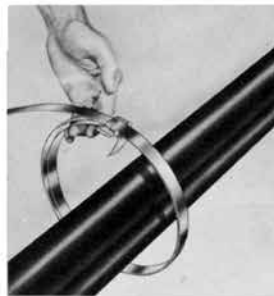

2 Continue band around object once more and again through buckle. DOUBLE BANDING DEVELOPS A GREAT DEAL MORE RADIAL COMPRESSION THAN SINGLE BANDING. Bend end of band under buckle.

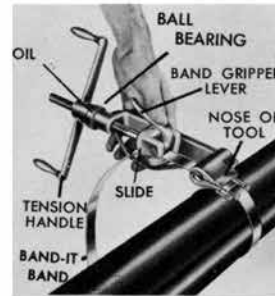

3 Place band in open slot of tool nose and in slide. With thumb on band gripper lever, apply tension by turning handle of tool. After tension is created, it is no longer necessary to hold band gripper lever as it locks itself under tension.



4 Place finger on BAND-IT BAND at buckle bridge while tensioning with tool handle. When you feel BAND-IT BAND stop moving through buckle as you are turning handle, MAXIMUM PRESSURE IS BEING EXERTED BY THE BAND-IT BAND around object being clamped. STOP TURNING HANDLE.



5 Roll tool over buckle, backing off with tension handle throughout entire rolling operation. Failure to back off with tension handle throughout entire course of roll may result in breaking of band. There is no loss of tension as band released is used up in the bend.



6 Pull cutting handle to cut the band.

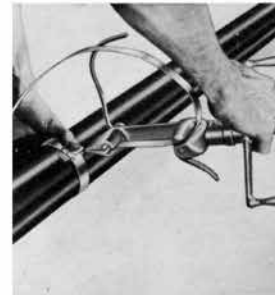

7 Remove tool, holding stub of band down with thumb.



8 Clinch stub by hammering down buckle ears, completing BAND-IT CLAMP.

BRACK-IT / BAND-IT®

POUR PANNEAUX DE SIGNALISATION. UTILISER AVEC BANDE 1/2" ET 3/4".
FOR SIGNS. USE WITH 1/2 «AND 3/4» TAPE.

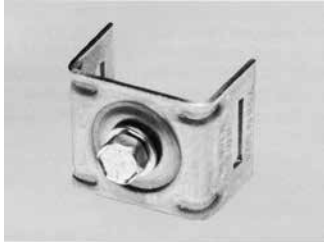

FIXATION EN ACIER INOXYDABLE

PATTES DROITES ET BOULON ACIER INOXYDABLE, RONDELLE ET RONDELLE FIBRE ASSEMBLÉ.

50 / BOÎTE

STAINLESS STEEL FLANGE

STRAIGHT LEGS AND STAINLESS STEEL BOLT, WASHER AND FIBER WASHER ASSEMBLED.

50 / BOX

#D001



FIXATION EN ACIER INOXYDABLE

PATTES ÉVASÉES ET BOULON ACIER INOXYDABLE, RONDELLE ET RONDELLE FIBRE ASSEMBLÉ.

50 / BOÎTE

STAINLESS STEEL FLANGE

FLARED LEGS AND STAINLESS STEEL BOLT, WASHER AND FIBER WASHER ASSEMBLED.

50 / BOX

#D021

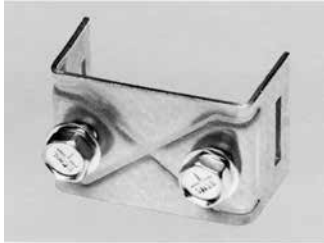

FIXATION DOUBLE EN ACIER INOXYDABLE

PATTES DROITES ET BOULON ACIER INOXYDABLE, RONDELLE ET RONDELLE FIBRE ASSEMBLÉ.

50 / BOÎTE

DOUBLE FLANGE MADE OF STAINLESS STEEL

STRAIGHT LEGS AND STAINLESS STEEL BOLT, WASHER AND FIBER WASHER ASSEMBLED.

50 / BOX

#D008



BOUCLE BAND-IT®

BAND-IT® BUCKLE

ACIER INOXYDABLE TYPE 201. 100 / BOÎTE
TYPE 201 STAINLESS STEEL. 100 / BOX

NUMÉRO	DIMENSION
#C253	3/8"
#C254	1/2"
#C256	3/4"



BOUCLE

BUCKLE

ACIER PLAQUÉ ZINC POUR BANDE 9MM.
100 / BOÎTE
ZINC PLATED STEEL FOR 9MM BAND.
100 / BOX

NUMÉRO	DIMENSION
#NB-B9	3/8"

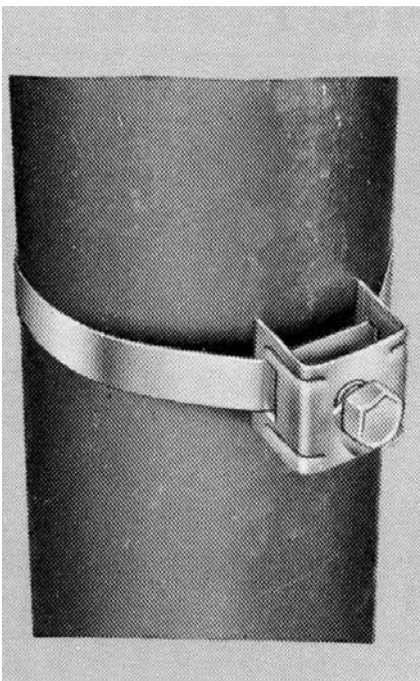

MINI-BRACK-IT / BAND-IT®

POUR PETITS PANNEAUX DE SIGNALISATION. UTILISER AVEC BANDE 1/2". 50 / BOÎTE
FOR SMALL SIGNS. USE WITH 1/2 «TAPE. 50 / BOX

FIXATION # D310

PATTES ÉVASÉES ET BOULON ACIER INOXYDABLE ASSEMBLÉ. 50 / BOÎTE

FLANGE # D310

FLARED LEGS AND STAINLESS STEEL BOLT ASSEMBLED. 50 / BOX

FIXATION #D315

PATTES DROITES ET BOULON ACIER INOXYDABLE ASSEMBLÉ. 50 / BOÎTE

FLANGE # D315

STRAIGHT LEGS AND STAINLESS STEEL BOLT ASSEMBLED. 50 / BOX

BOULON DE REMPLACEMENT

ACIER INOXYDABLE, TÊTE HEXAGONE 5/16"-24 X 1/2". 100 / BOÎTE

REPLACEMENT BOLT

STAINLESS STEEL, HEXAGON HEAD 5/16 «-24 X 1/2». 100 / BOX

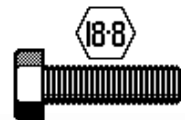
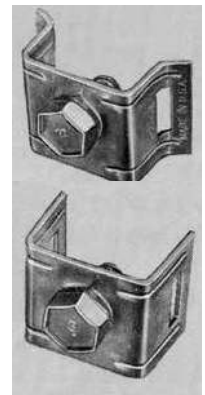

**CONTACTEZ-NOUS
GET IN TOUCH**

1 800 463-5259

info@prdistribution.ca

Notre service, toujours en tête.^{MD} Our service, one step ahead.TM

prdistribution.ca

1 800 463-5259
info@prdistribution.ca

Siège social • Head Office

6500, rue Zéphirin-Paquet
Québec QC G2C 0M3
T 418 872-6018 F 418 872-6583

Succursale • Branch

1100, rue de la Manic
Saguenay QC G7K 1A2
T 418 545-1100 F 418 545-1104

